

**Children's Sabbath School**

Cradle Roll, 0 - 3 years  
Kindergarten, 4 - 6 years  
Primary, 7 - 9 years  
Juniors, grades 5 & 6  
Earlites, grades 7 & 8

**Adult Classes**

Filipino (English) Class, Adult Quarterly, Pathfinder Room  
Tom Neslund, Adult Quarterly, North Room  
Spanish Class, Spanish Quarterly, Board Room  
Vietnamese Class, Viet. Quarterly, Mother's Room (Sanctuary)  
Friends in Prayer, "Lord I Have a Question", Upstairs Landing  
Dan Smith, "Revelation Revealing", Fellowship Hall

**Youth & Young Adults**

Youth, highschool ages 14 - 18, Library  
Young Adult, collegiate ages 18 & up, Youth Chapel

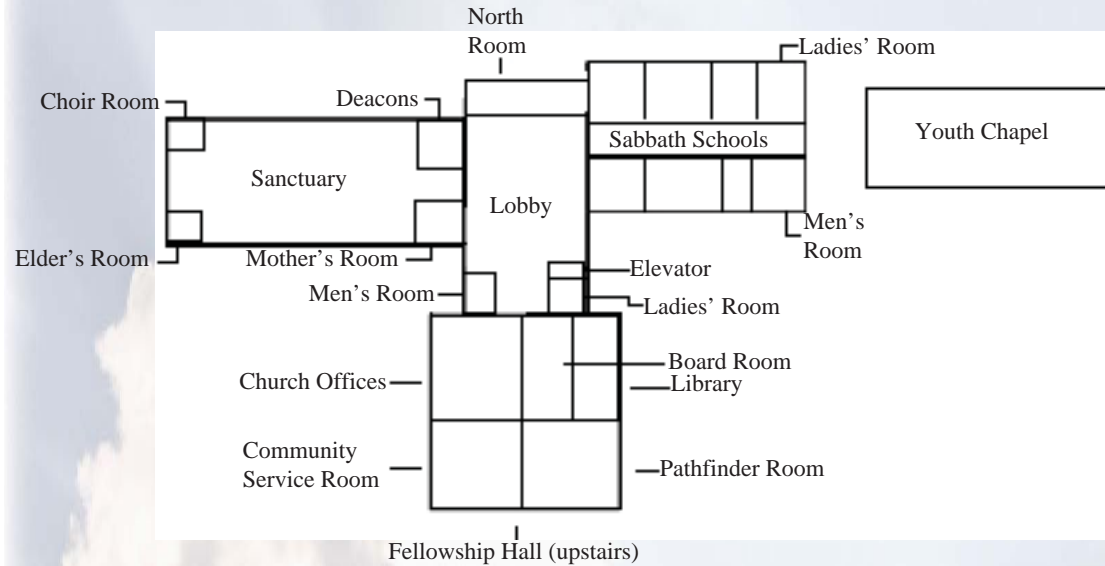

Our April 2011 budget is \$15,000.00.  
We have received \$3339.86.

Senior Pastor - Dan Smith, 951.359.4634 home; 951.236.7262 cell; [pastordan@gardengrovesda.com](mailto:pastordan@gardengrovesda.com)  
Young Adult Pastor, Shiphrah Fepulea'i (June), 760-224-4404, [shiphrah\\_f@yahoo.com](mailto:shiphrah_f@yahoo.com)  
Youth Pastor, Garrett Speyer (June), 530-518-6270; [garrett.speyer@wallawalla.edu](mailto:garrett.speyer@wallawalla.edu)  
Office Manager, Silvino J. Briceno, 714.534.1987 ext. \*110; f. 714-534-3877; [office@gardengrovesda.com](mailto:office@gardengrovesda.com)  
Bible Worker, Helen Sneed, ext. \*117; 714.979.4232  
Treasurer, Michele Lopez ext. \*115  
Life Coaching Program, Paula Hollmon, ext. \*112  
Community Services 714.534.4376  
Pathfinders/Adventurers - Alex Caldwell, 562.899.1925; [Acwaverun@MSN.com](mailto:Acwaverun@MSN.com).

Garden Grove Seventh-Day Adventist Church  
12702 9th Street, Garden Grove, CA 92840  
[www.gardengrovesda.com](http://www.gardengrovesda.com)  
Office Hours: Monday - Thursday 9:00 a.m. - 5:00 p.m.

Welcome to the  
*Garden Grove Seventh-day Adventist Church*  
April 9, 2011



### Prayer Concerns

Carol & Tasha Sneed	Joseph Estrada
Beth Trainor	Judy Harmon
The Holstein Family	Laura Lovio
Jon & Dolores Messina	

### Upcoming Events

Today	12:30	Potluck	FH
	2:30	Piano Concert	FH
	3pm	Lecture, Dr. Deihl	FH
	7pm	Thailand Benefit Concert	FH
	8:30	Movie Night	FH
Apr. 10	5am	Rummage Sale	Church Grounds
		Fam. Ministry Snow Day	
Apr. 14	6:30	Revelation Seminar	FH
	8pm	Choir Practice	MS
Apr. 16	2pm	C.H.I.P Training	FH
	7pm	Christian Edition Concert	MS
Apr. 22	7pm	FNL	YC
Apr. 23	11am	Easter Service	MS
	5:30	Children's Choir Concert	FH

### Worship Service

Please remember to put your phones and pagers on silent. Thank you!

Offering: Church Budget

Sabbath Rest continues until 7:08pm tonight. Next week's Sabbath welcome is at 7:13pm.

### Community Announcements

Community Services - Please continue to bring what you can to the community service room or the front office. M - Thur. 9am to 5pm.

**Your Youth Sabbath School** is beginning the New Year by saving change for tuition assistance. If you would like to save change for this project, you may bring it to the Youth Sabbath School room in the Library, or give it to Melissa Olson. So far we have received \$237.

Easter Lilies: The worship planning committee is looking to make our church as beautiful for Easter. If you are willing to donate a lily plant or two for the occasion, please let the

office know bring the lilies on Easter Sabbath morning, April 23rd. You may retrieve the lilies after the service.

**The snow day** sign up and money deadline is today

**Emergency forms** for the Revolve are due ASAP

### Incoming Memberships

Bruce Kelly	Calimesa
Mark Waldo	SCC Hispanic Region

### Outgoing Memberships

Erika Vining	Costa Mesa
--------------	------------

**We extend a special welcome to Drs. Hans and Lily Diehl of Loma Linda to our church. Hans Diehl, the founder of the CHIP program, is a Clinical Professor of Preventive Medicine in the School of Medicine at Loma Linda University. He lectures widely, is a bestselling author and an author of nearly 20 scientific publication on the clinical efficacy of the CHIP program. Don't miss his PM lecture about the reversibility of many of our chronic diseases through a well documented lifestyle medicine approach. Lily Pan Diehl, a recording artist both as vocalist and on pianist, will delight you with a special musical treat this afternoon. You want to be here --with your friends and neighbors-- for both afternoon programs.**

### Orangewood Corner

For more information about Orangewood Academy or Sunrise Christian Preschool please visit our website: [www.orangewoodacademy.com](http://www.orangewoodacademy.com)

## GARDEN GROVE SDA CHURCH

April 9, 2011  
10:50 a.m.

SONGS OF PRAISE	Garden Grove SDA Praise Team
WELCOME	Thomas Neslund
INVITING GODS PRESENCE	
CALL TO WORSHIP	Lisa Bethen
	<i>The Roman Soldier</i>
MORNING HYMN	Congregation
	Hymn 246, Worthy, Worthy is the Lamb
CHILDREN'S STORY	Lesieli Tameifuna
CALL FOR OFFERING	Hugo Leon
OFFERTORY	Sanctuary Choir
	<i>Behold the Lamb of God</i>
MORNING PRAYER	John Krell
SCRIPTURE	Carmen Stanish
	Luke 15:1-10
SPECIAL MUSIC*	Sanctuary Choir
	<i>Praise the Lord with Jubilant Song</i>
MORNING MESSAGE	Hans Diehl
	<i>MAD, SAD, GLAD: The Gospel of Second Chance!</i>
THE BLESSING*	Thomas Neslund
CLOSING MEDITATION*	Lily Diehl
	<i>Please Remain Seated For The Closing Meditation</i>

*Today's Worship Planner is Lisa Bethen*

*\* Out of respect to the worshippers, Deacons will close Sanctuary doors to be reopened immediately thereafter.*